

BLACK REBAR DENOTES FULL CELL (0.00460417 CUBIC YARD)

WHITE REBAR DENOTES INTERIOR STRETCHER CELL (0.0021328 CUBIC YARD)

FULL CELL REBAR IS PLACED 4" IN FROM THE EXTERIOR EDGES
(SAME AS STANDARD CMU)

STRETCHER CELL REBAR IS 2 1/2" IN FROM THE INTERIOR EDGES OR 5 1/2"
FROM THE EXTERIOR EDGES

TYPICAL VERTICAL REBAR PLACEMENT PER ENGINEERING IS ONE #5 @ 48" O.C.
AND ADJACENT TO EVERY WINDOW AND DOOR OPENING

2 1/2"
STRETCHER

DATE: 08-16-18
REVISION:

PAGE: SDI

SHOP DRAWING
REBAR PLACEMENT - GENERAL NOTES



ALL REBAR TYPICALLY #5

SHOP DRAWING OVERVIEW

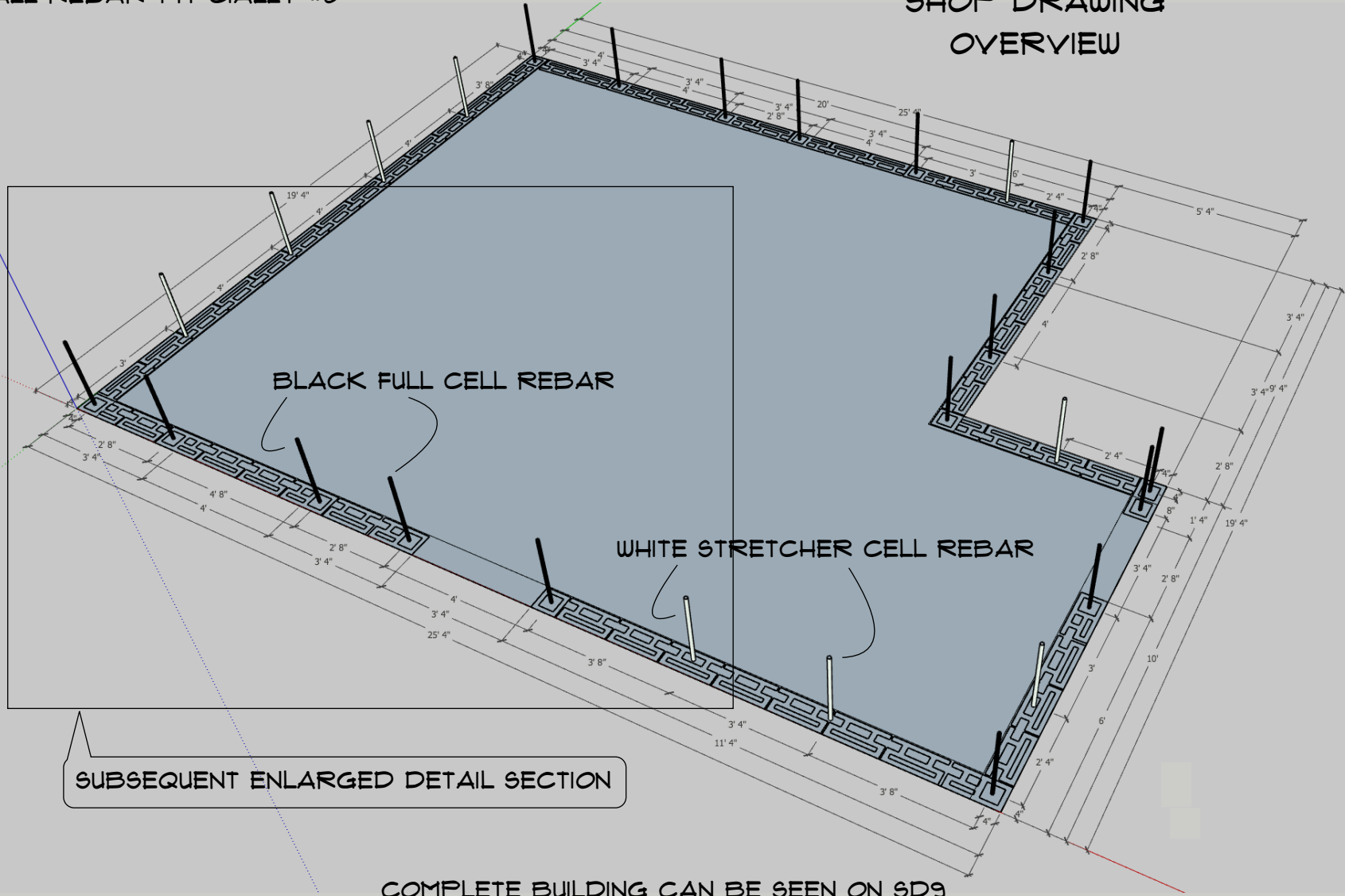

SUBSEQUENT ENLARGED DETAIL SECTION

COMPLETE BUILDING CAN BE SEEN ON SD9

DATE: 08-16-18
REVISION:

PAGE: SD2

SHOP DRAWING
REBAR PLACEMENT - OVERVIEW



REBAR 4Ø BAR DIAMETERS
FROM FINISHED FLOOR HEIGHT

SHOP DRAWING SECTION DETAIL

BEST DESIGN PRACTICES CALL FOR
ALL DIMENSIONS TO BE EVENLY
DIVISIBLE BY 8" (BLOCK MODULE)

3'4" DOOR OPENING

4' DIMENSION IS WHERE
A 4Ø4Ø WINDOW WILL
BE LOCATED WITH A
4'0" SILL HEIGHT AND
AN 8'0" CROSSOVER

FIRST DIMENSION LAYER: REBAR PLACEMENT
SECOND DIMENSION LAYER: JAMB-TO-JAMB

DATE: 08-16-18
REVISION:

PAGE: SD3

SHOP DRAWING
SECTION DETAIL



ALL NON-REBAR CELLS FILLED WITH OMNI BLOCK INSULATION INSERTS (NOT SHOWN)

SHOP DRAWING SECTION DETAIL - FIRST COURSE

BEST DESIGN PRACTICES CALL FOR ALL DIMENSIONS TO BE EVENLY DIVISIBLE BY 8" (BLOCK MODULE)

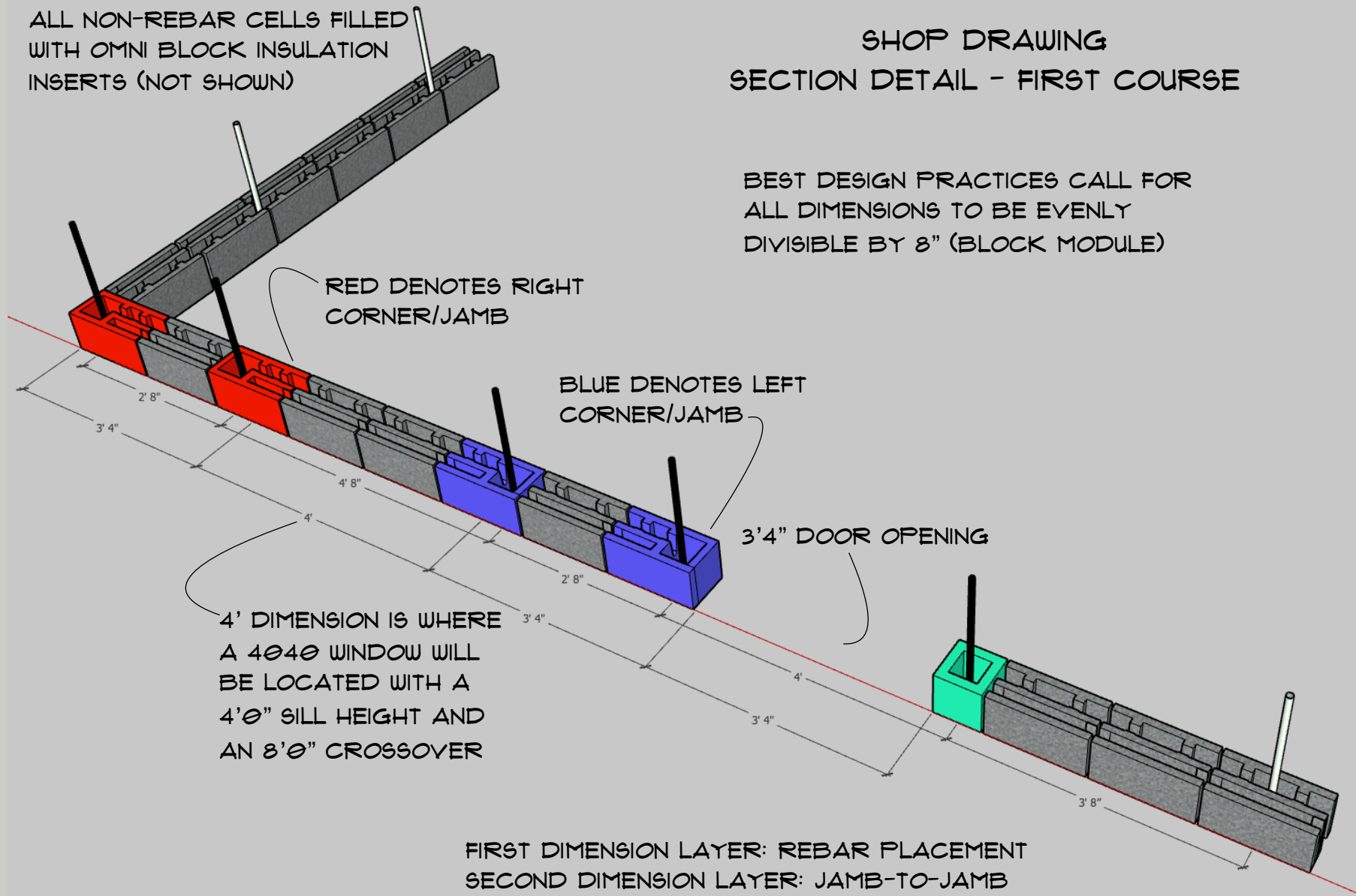

DATE: 08-16-18
REVISION:

PAGE: SD4

SHOP DRAWING
SECTION DETAIL - FIRST COURSE



ALL NON-REBAR CELLS FILLED
WITH OMNI BLOCK INSULATION
INSERTS (NOT SHOWN)

SHOP DRAWING SECTION DETAIL - SECOND COURSE

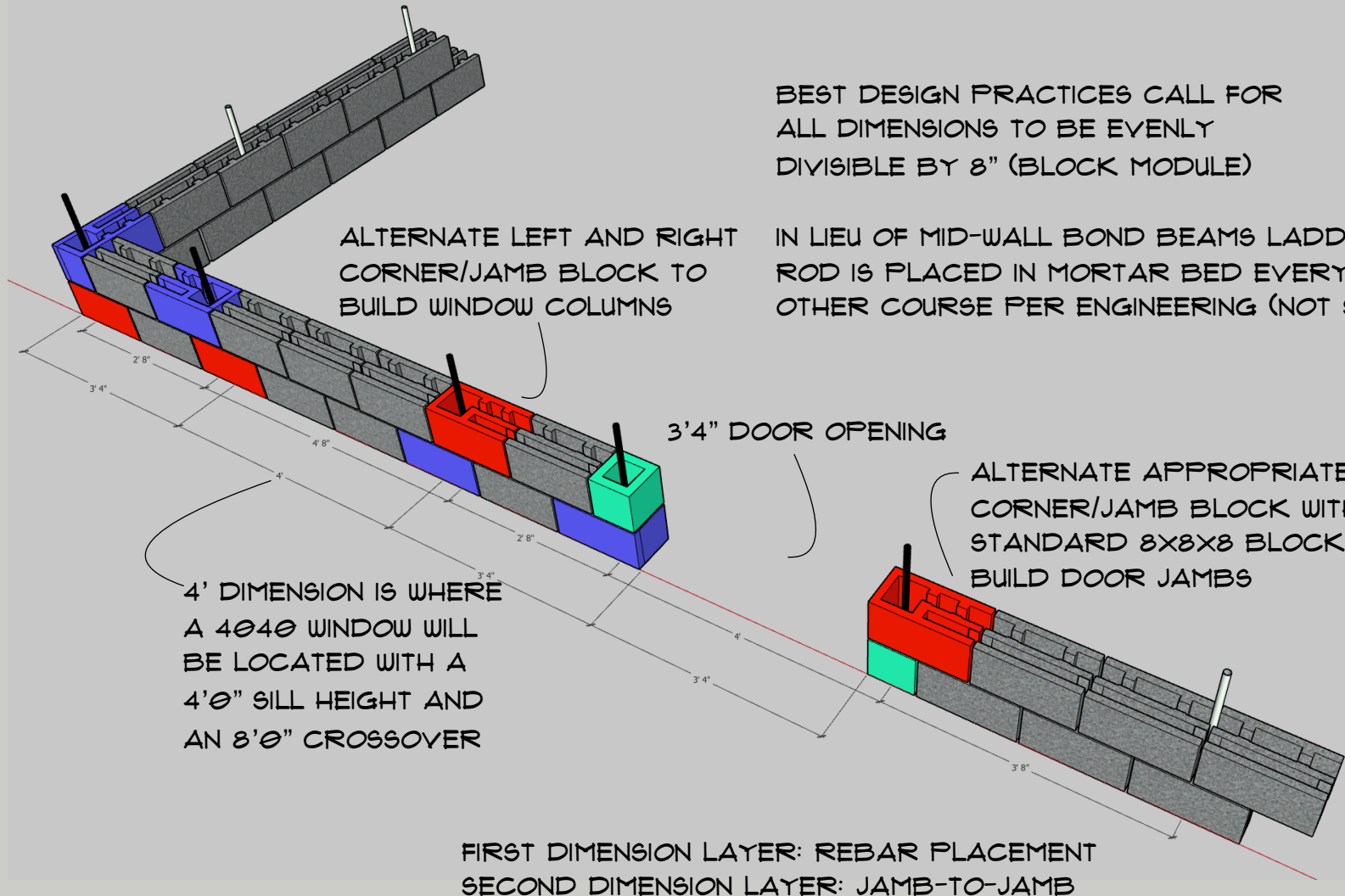

DATE: 08-16-18
REVISION:

PAGE: SD5

SHOP DRAWING
SECTION DETAIL - SECOND COURSE



SHOP DRAWING
SECTION DETAIL - 4 FT LIFT

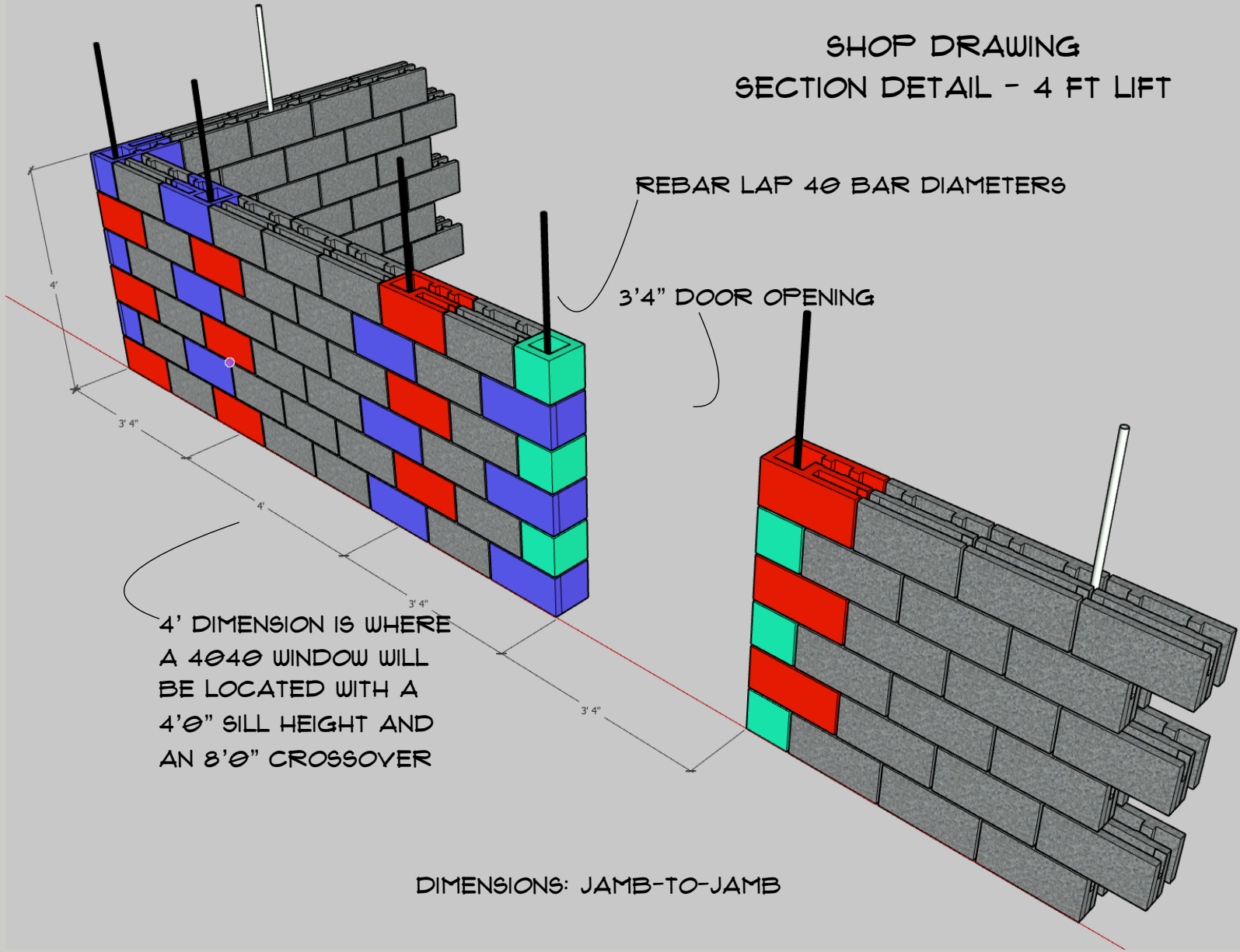

DATE: 08-16-18
REVISION:

PAGE: SD6

SHOP DRAWING
SECTION DETAIL - 4 FT LIFT



SHOP DRAWING
SECTION DETAIL - 8 FT LIFT

REBAR LAP 4Ø BAR DIAMETERS

4Ø4Ø WINDOW OPENING

3'4" DOOR OPENING

DIMENSIONS: JAMB-TO-JAMB

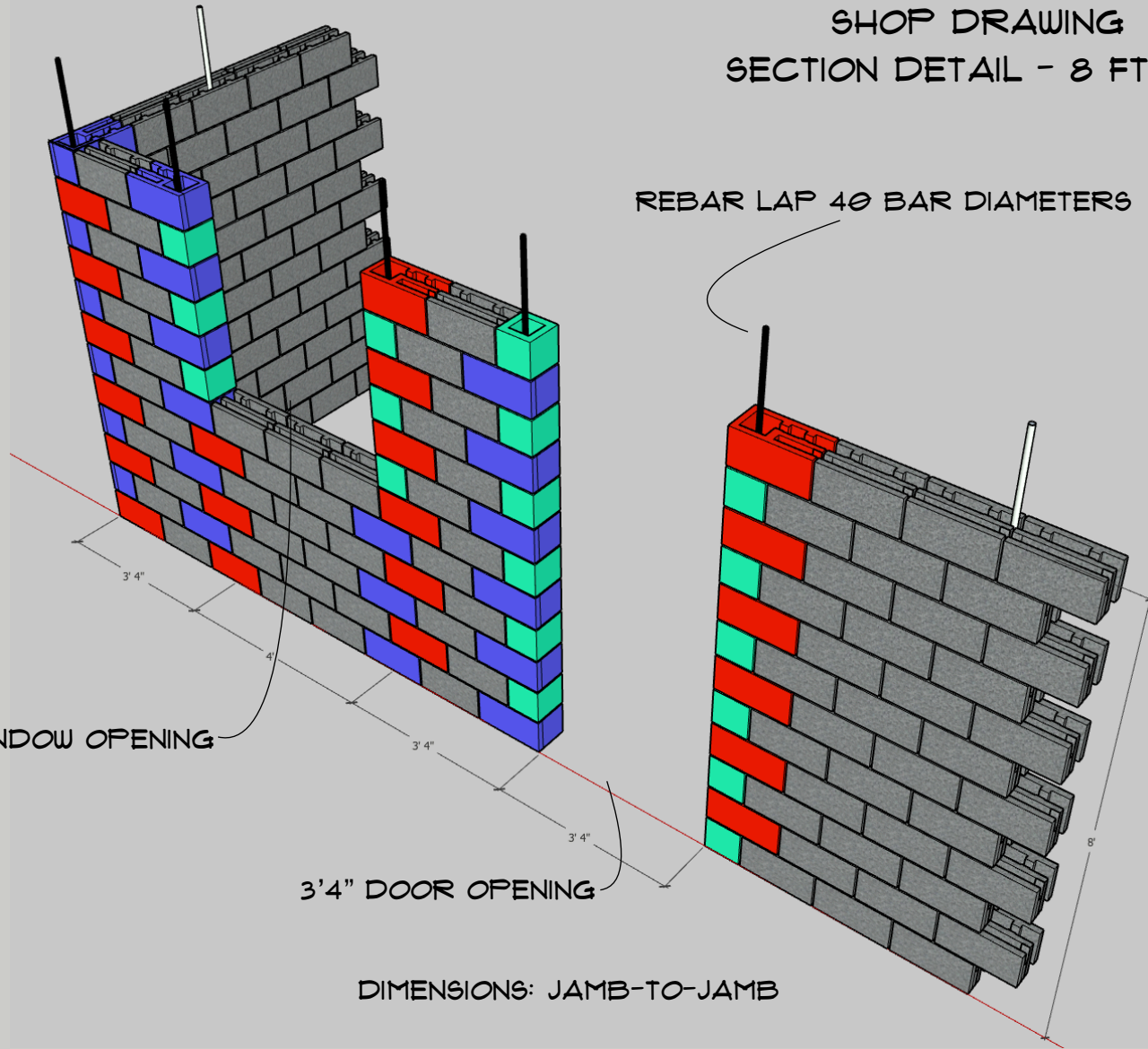

DATE: 08-16-18
REVISION:

PAGE: SD1

SHOP DRAWING
SECTION DETAIL - 8 FT LIFT



SHOP DRAWING
SECTION DETAIL - 10 FT TOP OUT

USE OMNI BLOCK IF ONE #5 TOP-OF-WALL IS REQUIRED
OR
STANDARD BOND BEAM CMU IF TWO #5 ARE REQUIRED

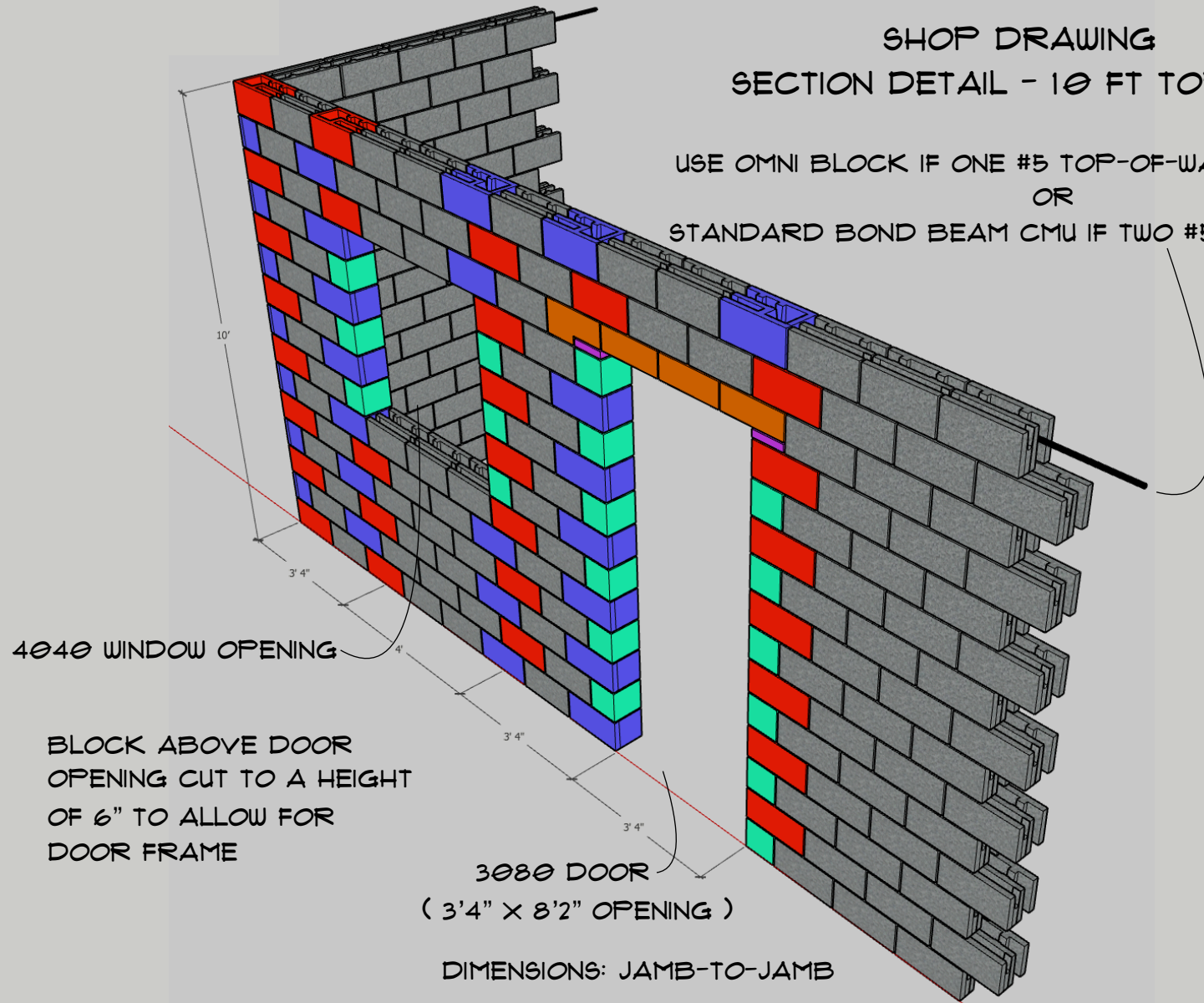

DATE: 08-16-18
REVISION:

PAGE: SD8

SHOP DRAWING
SECTION DETAIL - 10 FT TOP OUT



SHOP DRAWING
COMPLETE BUILDING

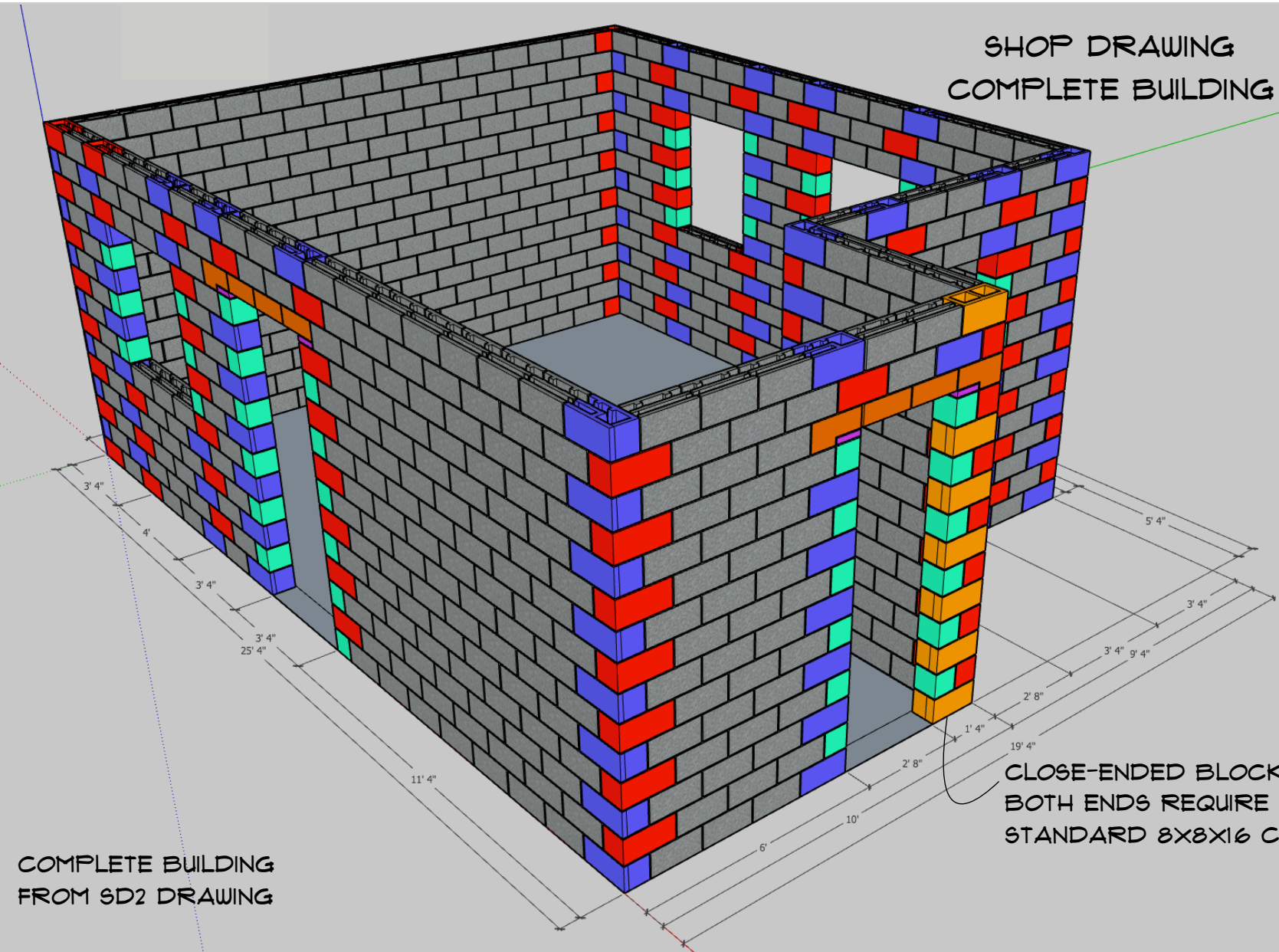

COMPLETE BUILDING
FROM SD2 DRAWING

CLOSE-ENDED BLOCK
BOTH ENDS REQUIRE
STANDARD 8X8X16 CMU

DATE: 08-16-18
REVISION:

PAGE: SD9

SHOP DRAWING
COMPLETE BUILDING

